

DYNAMIC STANDING FRAME

ACTIVALL™



ASSEMBLY MANUAL

AKCES[®]MED



CAUTION! Manufacturer takes responsibility for proper usage of the device only when the product was purchased from qualified Akces-Med employee or at specialized medical store.



ISO 13485
CERTIFIED COMPANY

Medical product first class according to the Regulation 93/42/EEG of European Parliament and Council regarding medical products.
For this product the producer issued relevant declaration of conformity.
Producer's identification number in the Registration Department of Healing Products, Medical Products and Biocide Products:

PL/CA01 04088/W

Akces-Med Sp. z o.o. Company introduced quality management system ISO 13485 regarding production, sales and service.

The system is certified by Det Norske Veritas.

**QUALITY
MANAGEMENT
SYSTEM**



LIST OF ELEMENTS:



(1) Pelotte from chest brace (1 pcs)

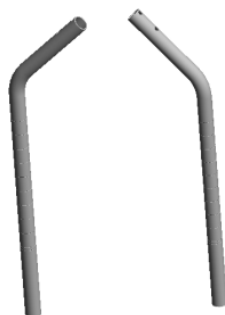

(2) Bracket from chest brace (2 pcs)



(3) Pelotte from pelvic brace (1 pcs)

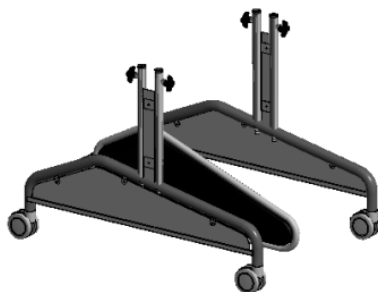

(4) Base with castors (1 pcs)



(5) M6 screw (8 pcs)



(6) M6 hexagon nut (8 pcs)

DESCRIPTION ON HOW TO ASSEMBLE ACTIVALL STANDING FRAME

Please follow these steps so as to unfold ACTIVALL:

STAGE 1. Assemble chest brace :

- insert bracket from chest brace (2) into frames of chest pelotte (1) on its both sides;

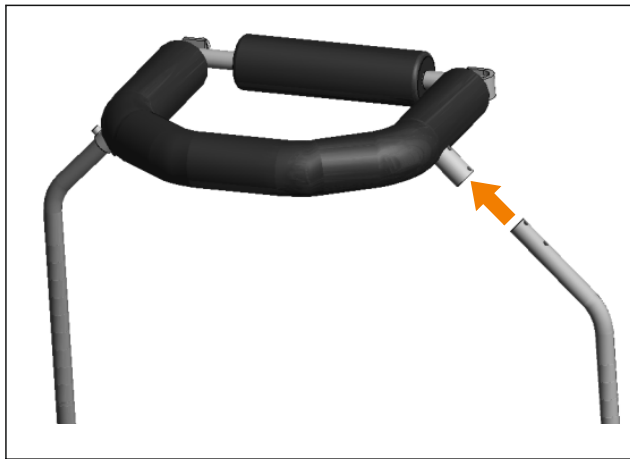

- next, brackets (2) should be mounted with the aid of screw (5) as well as nut (6). Screws together with nuts (there are two sets on both sides of brace) should be inserted into holes and fastened by means of Allen wrench.

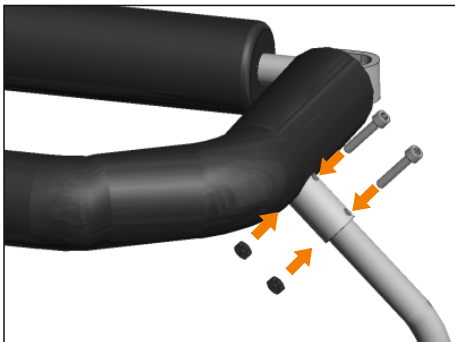

STAGE 2. Assemble pelvic brace

- place brackets from pelvic pelotte at an angle 90°;

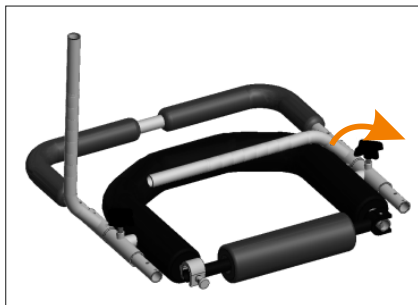
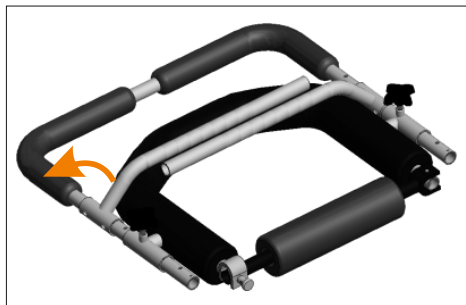

- next, brackets should be mounted on pelvic pelotte (3) with the aid of screw (5) as well as nut (6). Screws together with nuts (there are two sets on both sides of brace) should be inserted into holes and fastened by means of Allen wrench.

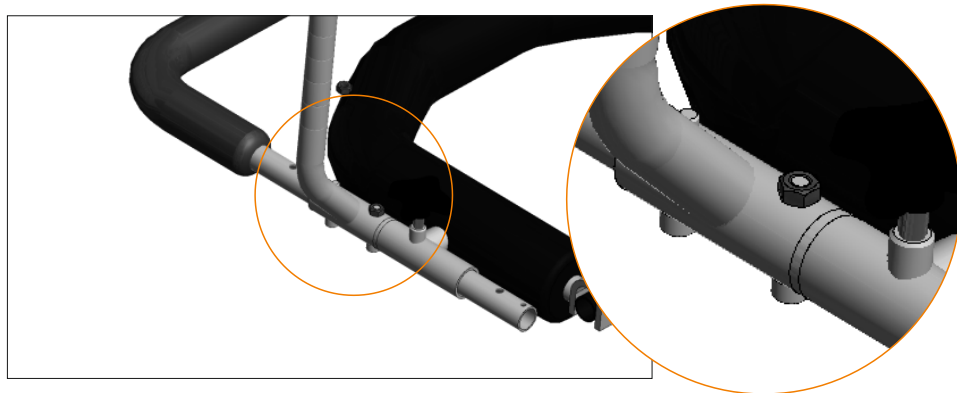
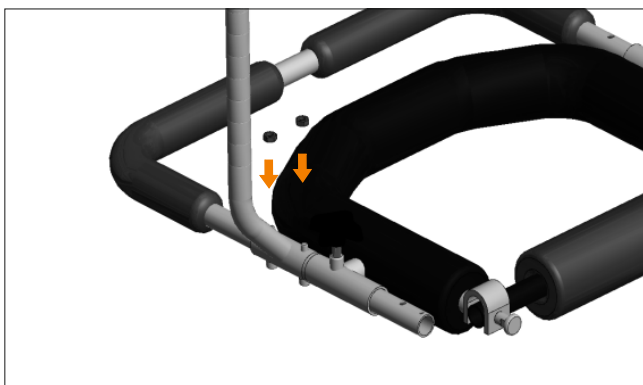
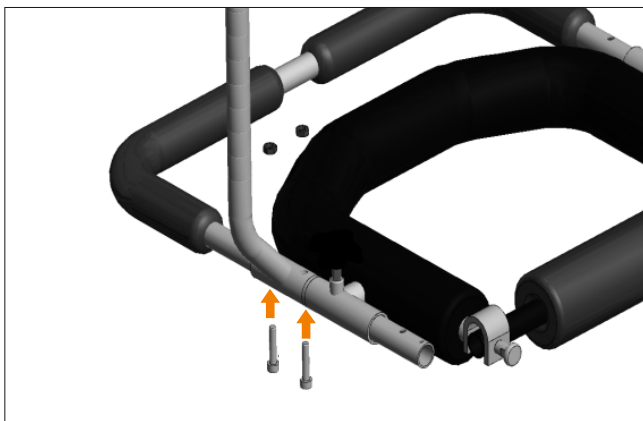

STAGE 3. Place pelvic brace (3) on the base with castors (4) :

- insert brackets from pelvic brace into first frame from the base with castors (4).



It is necessary to tighten firmly knobs once brace is mounted as well as its height is adjusted!



STAGE 4. Place chest brace (3) on the base with castors (4) :

- insert brackets from chest brace into second frame from the base with castors (4).



It is necessary to tighten firmly knobs once brace is mounted and its height is adjusted!



STAGE 5. Place pelvis stabilizing harness and fasten it on pelvic pelotte.

Correctly mounted Activall. Remember to adjust product to the patient before use!





ORTHOPAEDIC DEVICES MANUFACTURER



Akces-MED. Sp. z o.o.
ul. Leszka Czarnego 3
35-615 Rzeszów
tel. (17) 864 04 70

www.akces-med.com

e-mail: akces-med@akces-med.com

Authorised Dealer



Date of issue: 10.11.2014

The last update: 16.04.2015

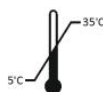

AKCES-MED Ltd. reserve the right to introduce technical and trading changes
in the content of the instruction without warning.